

Wooden Blind Fitting Instructions

MOUNTING HARDWARE

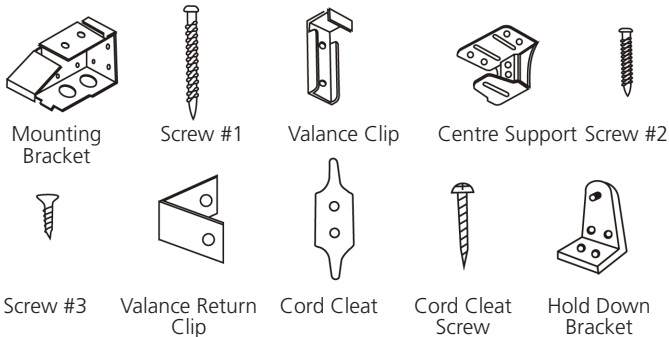

(Note: Centre support supplied for blind width 100cm or over)

TOOLS RECOMMENDED FOR INSTALLATION:

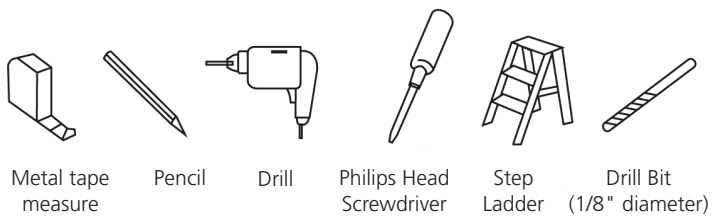

WARNING

Children can be strangled in blind or drapery cords. To keep cords out of reach of children, use these methods:

1. Clamp
2. Cleat
3. Tie the cord to itself
4. Tie-down device

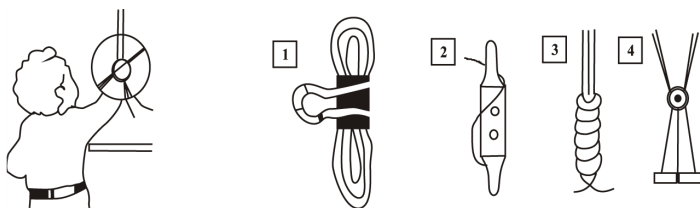

WARNING

Young children can strangle in the loop of pull cords, chains, tapes that operate window coverings. They can also wrap the cords around their necks. To avoid the risk of strangulation and entanglement, keep cords out of the reach of young children. Move beds, cots and furniture away from window covering cords.



MOUNTING INSTRUCTIONS

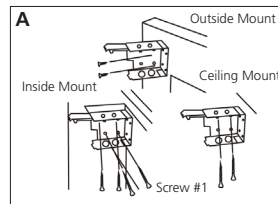

A. Brackets should be placed at the width of blinds headrail 6mm past each end. The bracket doesn't necessarily need to touch the inside face of the window frame.

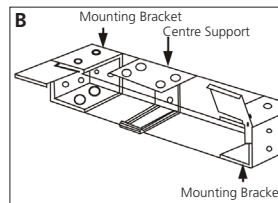

B. Align the top of the centre support bracket with the top of the mounting bracket before installation. Install with the bigger flap of the centre support bracket on the top side and clear of the slat ladder positions.

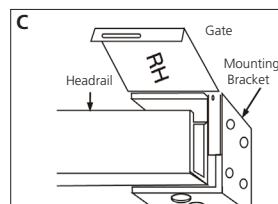

C. Push rail into brackets. Then press gate to close brackets.

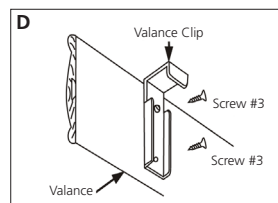

D. Screw valance clips onto back side of the valance with screws provided (Screw #3)

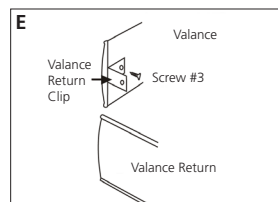

E. For Outside Mount: Screw one end of the valance return clip onto the valance using Screw #3. Align the edge of the valance return with the valance. Screw the other end of the valance clip onto the valance return.

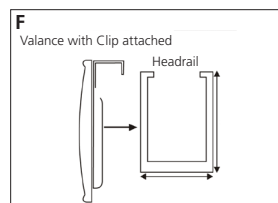

F. Hook valance clip with valance attached onto the top of the headrail.

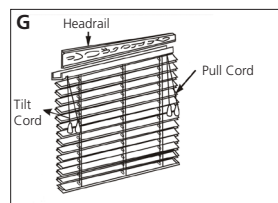

G. Always tilt blind horizontally before raising/lowering to extend the life of the blind. **To lower blind:** Move cord to left pulling down gently until cord lock releases. **To raise blind:** Pull cord downward until blind reaches desired height. **To lock cords:** Pull cord right and release. Cord will lock automatically.

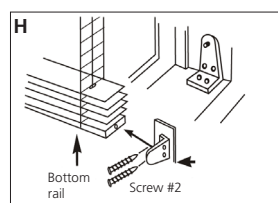

Installing Hold Down Brackets (Optional)
H. Hold down brackets: Using two small screws, screw hold down bracket to window facing or wall. Snap bracket pin ends into the hole at bottom rail end.

Wooden Blind Fitting Instructions

WARNING

Reduce risk of strangulation to infants and toddlers.
Position safety cord-stops before using blinds.

TO POSITION SAFETY CORD-STOPS:

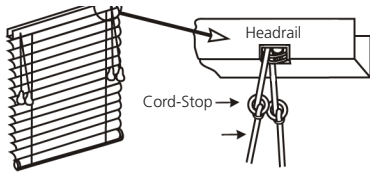

1. Install blind as directed by manufacturer making sure headrail is securely fastened. Lower blind to maximum desired length and lock into place.

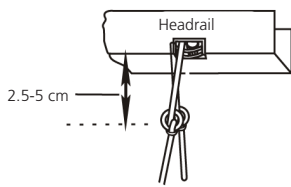

2. Measure the distance from headrail to cord-stops. If cord-stops are 2.5cm to 5cm below the headrail no further adjustment is needed. Your blind is ready to be used.

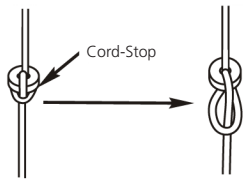

3. If cord-stops ARE NOT 2.5cm to 5cm below headrail loosened (but do not untie) the knot surrounding the cord-stop.

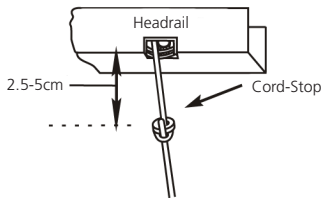

4. Push both the cord-stop and the loosened knot toward the headrail until the cord-stop is 2.5cm to 5cm below the headrail. Hold cord-stop in place and pull firmly on lift cord to re-tighten knot. Repeat steps 2, 3 & 4 for each cord-stop.

(Note: Use of hold down bracket is recommended to fully utilise the safety feature of the cord-stops)

SAFETY CLEAT FITTING INSTRUCTIONS

STEP 1

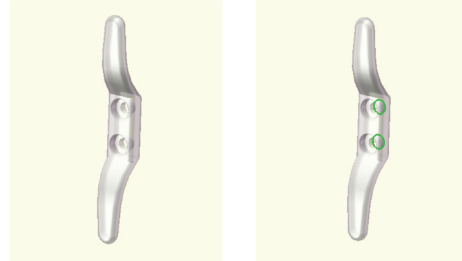

- Place safety cleat in the desired location on the wall and mark the position of the two holes using a pencil.
- We recommend position the cleat to either side of the blind and out of the reach of children

STEP 2

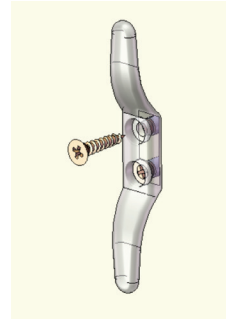

- Remove the safety cleat and drill the position marked Once the holes are drilled place a rawplug into the holes
- Use the screws provided to attach the safety cleat to the wall

STEP 3



- We recommend that the cord is wrapped around the safety cleat when the blind is not in use, as shown in the pictures below.

RECOMMENDED CARE FOR WOODEN BLINDS

1. When opening or closing blind only raise or lower the blind when the slats are in the horizontal (open) position. Larger blinds must be raised or lowered in stages. Raising or lowering in one singular motion places excessive stress on the mechanism, strings and brackets. Do not force the cord when tilting the blinds, this may cause the mechanism to break.

2. It is not recommended that wooden blinds be fitted in damp or wet environments as warpage may occur.

3. Dust blinds regularly.

4. If the blind becomes damp or wet, wipe down immediately. The slats should be horizontal (open) and the blind released and lowered completely. Allow to dry by removing the blinds from the brackets and lay down on a hard surface. Do not place in direct sunlight as excessive heat may cause the slats to warp. If the blinds are excessively wet do not place the blinds on a surface that may absorb any stain.

5. This wooden blind does not require any oiling.

If you have any doubts about the care or maintenance of your wooden blind do not hesitate to contact your nearest supplier for advice.